

Soils Map

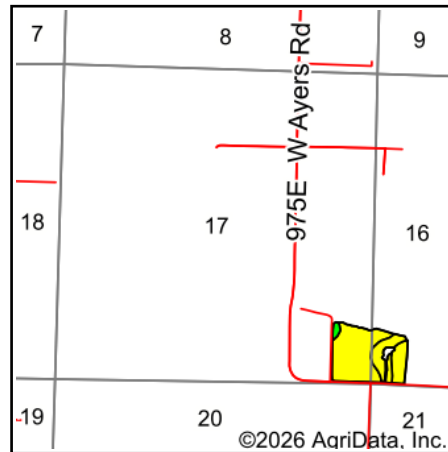

State: **Illinois**
 County: **Bond**
 Location: **17-6N-3W**
 Township: **Lagrange**
 Acres: **25**
 Date: **2/24/2026**

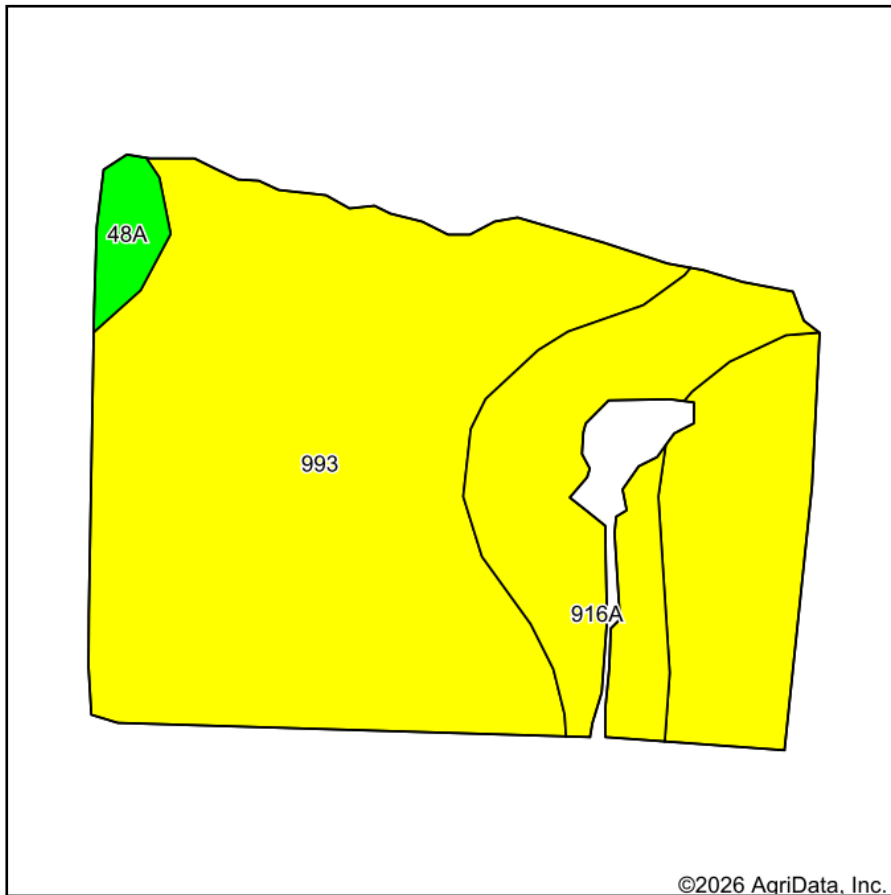

Soils data provided by USDA and NRCS.

Area Symbol: IL005, Soil Area Version: 21													
Code	Soil Description	Acres	Percent of field	Il. State Productivity Index Legend	Subsoil rooting ^a	Corn Bu/A	Soybeans Bu/A	Wheat Bu/A	Oats Bu/A ^b	Sorghum ^c Bu/A	Grass-legume ^e hay, T/A	Crop productivity index for optimum management	*n NCCPI Soybeans
993	Cowden-Piasa silt loams	19.64	78.6%		FAV	149	49	59	30	65	5.00	111	54
916A	Oconee-Darmstadt silt loams, 0 to 2 percent slopes	4.73	18.9%		FAV	144	47	55	0	110	5.00	108	61
48A	Ebbert silt loam, 0 to 2 percent slopes	0.63	2.5%		FAV	173	55	66	0	124	5.00	125	53
Weighted Average						148.7	48.8	58.4	23.6	75	5	110.8	*n 55.3

Table: Optimum Crop Productivity Ratings for Illinois Soil EFOTG are sourced from Bulletin 811 calculated Map Unit Base Yield Indices, and adjusted (Adj) for slope, erosion, flooding, and surface texture. Publication Date: 02-08-2023

Crop yields and productivity (B811 EFOTG) are maintained at the following USDA web site: 2023 Illinois Soil Productivity and Yield Indices: <https://efotg.sc.egov.usda.gov/#/state/IL/documents/section=2&folder=52809>

** Base indexes from Bulletin 811 adjusted for slope, erosion, flooding, and surface texture according to the Il. Soils EFOTG

^b Soils in the southern region were not rated for oats and are shown with a zero "0".

^c Soils in the northern region or in both regions were not rated for grain sorghum and are shown with a zero "0".

^e Soils in the well drained group were not rated for grass-legume and are shown with a zero "0".

*n: The aggregation method is "Weighted Average using all components"